

Phase spacing arc plate installation

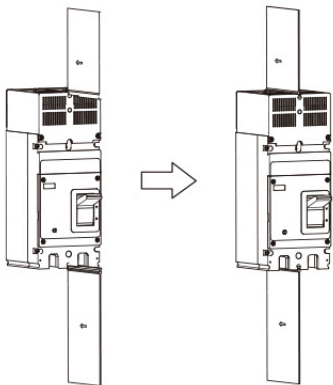

1. The protective cover must be installed before the product runs
2. Check whether the product is properly connected
3. After installation, check that the ground insulation resistance is no less than 10 MΩ

Installation of diaphragms and shields

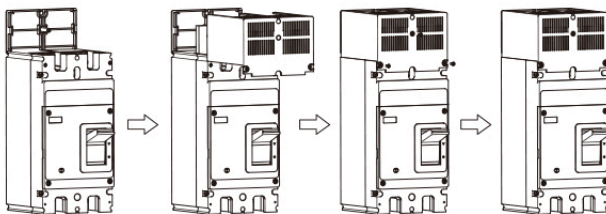

Certificate Qualification

Name: DC High Voltage

Molded Case Circuit Breaker

The product has passed the inspection and conforms to the standards: IEC/EN 60947-2 and GB/T 14048.2, and is approved for delivery.

Inspector: _____



Date of inspection: _____

DC High Voltage
Molded Case Circuit Breaker

Instruction Manual

Thank you for buying this product. Please read the instructions carefully before installing, using or maintaining the product.

Safety Tips

1. The product is strictly prohibited to be installed in an environment containing flammable and explosive gas and wet condensation, and it is strictly prohibited to operate the product with wet hands;
2. During the work of the product, it is strictly prohibited to touch the conductive parts of the product;
3. When installing, maintaining and maintaining products, ensure that the line is powered off;
4. Do not install in places where gas medium can corrode metal and destroy insulation;
5. In order to avoid dangerous accidents, the installation and fixing of the product shall be carried out in strict accordance with the requirements of the manual.

Usage Information

1. The ambient temperature for normal use of the product is $-5^{\circ}\text{C}\sim+40^{\circ}\text{C}$;
- Note: If used in the range of -35°C to $+70^{\circ}\text{C}$, please consult with the manufacturer for use.
2. When the altitude exceeds 2000m, please consult with the manufacturer for use;
 3. Pollution level: Level 3
 4. Main circuit installation category: III;
 5. Shell protection grade: IP20.

Warranty Period

The warranty period of the product is 24 months from the date of production under normal storage and transportation conditions and the product packaging or the product itself is in good condition. The following conditions are not covered by warranty:

1. Damage caused by improper use, storage and maintenance of users;
2. Damage caused by disassembly and maintenance not assigned by the company or personnel;
3. The product exceeds the warranty period;
4. Damage caused by force majeure.

Environmental Protection

In order to protect the environment, when this product or its parts are scrapped, please properly dispose of it as industrial waste; Or to the recycling station in accordance with the relevant national regulations for classification, disassembly, recycling and reuse.

Inspection and Testing

Check

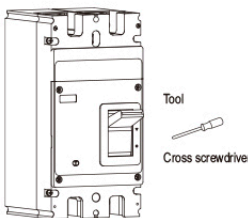

1. Determine product technical parameters;
2. Installation, operation and maintenance of the product are only performed by qualified personnel.

Frame	Mounting screw	Quantity
125/160	M4×45	2(2P)
250/320	M4×60	2(2P)/4(3P)
400/630/800	M5×110	2(2P)/4(3P)

Minimum mounting distance

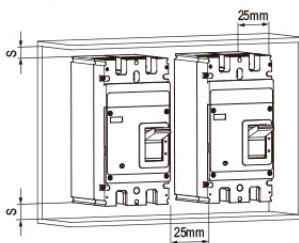

Ensure minimum mounting distance

Frame	S
125/160	100
250/320	100
400/630/800	100

Test

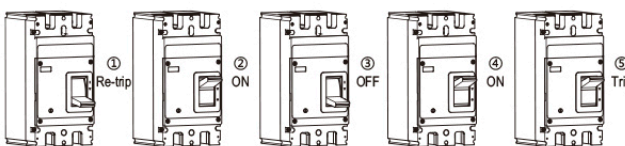

Outline Overall and Installing Dimensions

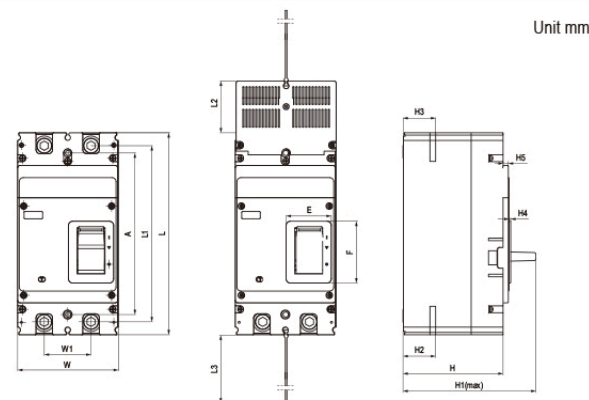

Size class	Dimension code	125/160 Frame			250/320 Frame			400/630/800 Frame		
		2-pole			2-pole			2-pole		
Overall dimension	L	150	180	180	250	250	250	250	250	250
	L1	134	160	160	218	218	218	218	218	218
	L2/L3	48	90	65/90	65/100	65/100	65/100	65/100	65/100	65/100
	W	64	76	107	124	124	124	124	124	124
	W1	30	35	35	58	58	58	58	58	58
	E	29	24	24	56	56	56	56	56	56
	F	52	46	46	76	76	76	76	76	76
	H	68	97.5	97.5	123	123	123	123	123	123
	H1	95	126	126	163	163	163	163	163	163
	H2	24.5	29.5	29.5	60	60	60	60	60	60
	H3	24.5	29.5	29.5	60	60	60	60	60	60
	H4	1	1	1	1.5	1.5	1.5	1.5	1.5	1.5
	H5	6	6	6	6.5	6.5	6.5	6.5	6.5	6.5
	A	129	141	141	200	200	200	200	200	200
Mounting dimension	Φd	4.2	4.2	4.2	6.5	6.5	6.5	6.5	6.5	6.5

Installation Wiring

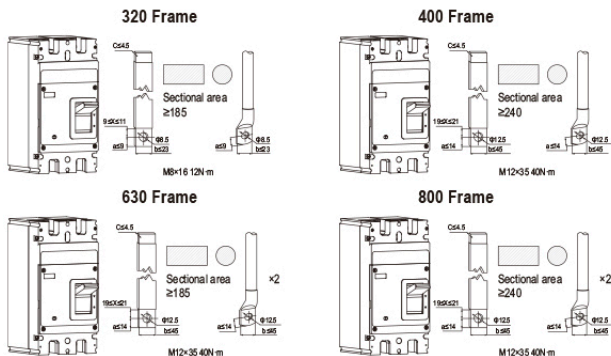

Attachment Information

Auxiliary contact wiring diagram

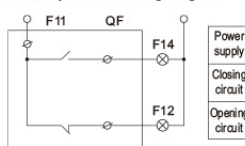

Shunt trip wiring diagram

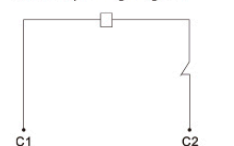

Undervoltage release wiring diagram

